

**Parting-off and grooving Tools**  
**Abstech- und Nutendrehwerkzeuge**  
**Avsticknings- och spårvarvningsverktyg**

**A:** A1–A173

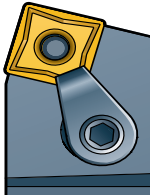

**Turning tools to ISO**  
**Drehwerkzeuge nach ISO**  
**Svarvverktyg enligt ISO**

**B:** B1–B209

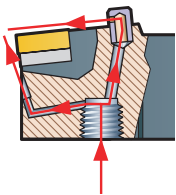

**Micro-lubrication system for turning tools**  
**Minimalschmiersystem für Drehwerkzeuge**  
**Minimalsmörjsystem för svarvverktyg**

**C:** C1–C23



**Mini-tools for automatic machines**  
**Miniatuurwerkzeuge für Drehautomaten**  
**Miniverktyg för automatsvarvar**

**D:** D1–D53

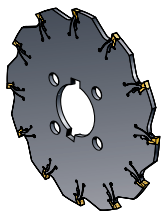

**Groove milling tools**  
**Nutenfräswerkzeuge**  
**Spårfräsverktyg**

**E:** E1–E36

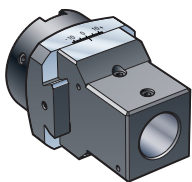

**Boring heads**  
**Ausdrehköpfe**  
**Borrhuvuden**

**F:** F1–F39

**Material cross reference**  
**Werkstoff Querverweis**  
**Korsreferens för material**

**G:** G1–G4

# A:

## Colour marking: – Farbezeichen: – Färgmärkning:

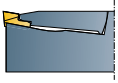

 Radial, external – Radial, aussen – Radiellt, utvändigt

 Axial – Axial – Axiellt

 Radial, internal – Radial, innen – Radiellt, invändigt

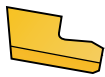

 Inserts – Schneiden – Skär

 Insert grades, cutting data – Schneidensorten, Schnittdaten – Skärsorter, skärdata

 Miscellaneous – Verschiedenes – Diverse

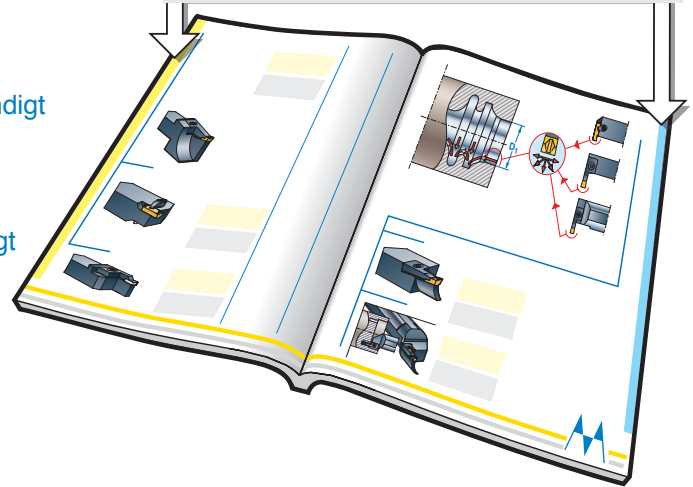



# MIRCONA<sup>A</sup>

**Parting-off and Grooving Tools**  
**Abstech- und Nutendrehwerkzeuge**  
**Avsticknings- och spårvarvningsverktyg**



Table of Contents	Inhaltsverzeichnis	Innehållsförteckning	Page-Seite-Sida
The tool system	Das Werkzeugsystem	Verktygssystemet	<b>A12–A13</b>
Code key	Kodeschlüssel	Kodnyckel	<b>A14–A15</b>
Selection of cutting tool	Wahl der Schneidwerkzeuge	Val av skärverktyg	<b>A16–A17</b>
Machining hints	Bearbeitungshinweise	Bearbetningstips	<b>A62–A63</b>
General recommendations	Allgemeine Empfehlungen	Allmänna rekommendationer	<b>A64–A65</b>
Cutting data:	Schnittdaten:	Skärdata:	<b>A158–A169</b>
Carbide grades	Hartmetallsorten	Hårdmetallsorter	<b>A124–A128, A150–A153, A171</b>
Product index	Alphabetisches Register	Alfabetiskt register	<b>A170</b>

**A**

Tool holder	Applications	Recommendations; Page	Technical specifications; Page
Klemmhalter	Anwendungsbereich	Empfehlungen; Seite	Technische Spezifikationen; Seite
Verktygshållare	Användningsområde	Rekommendationer; Sida	Tekniska specifikationer; Sida

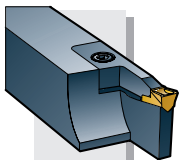

**151F**

**151FA**

**A66–A68**

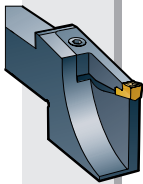

**151RF**

**A69**

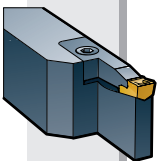

**151S**

**A70**

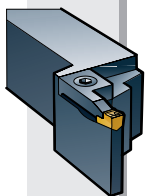

**151G**

**151GA**

Circlip grooves  
Sicherungsringnuten  
Låsringsspår

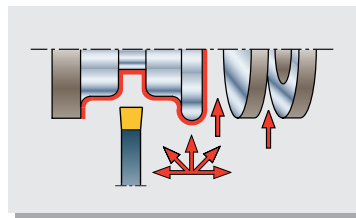

**A18–A22**

**A72–A73**

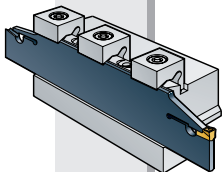

**156C**

**TB56C**

**A74–A75**

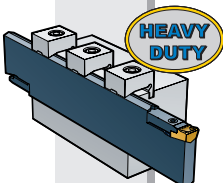

**156S**

**TB56S**

**HD56S**

**HEAVY DUTY**

**A76–A79**